

Techn. Data: Enzo C/1

Log length (W x D): 400 x 500 cm

Wall size(outside): 380 x 480 cm · Log thickness: 40 mm

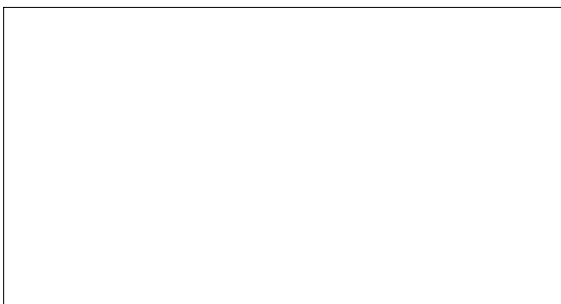
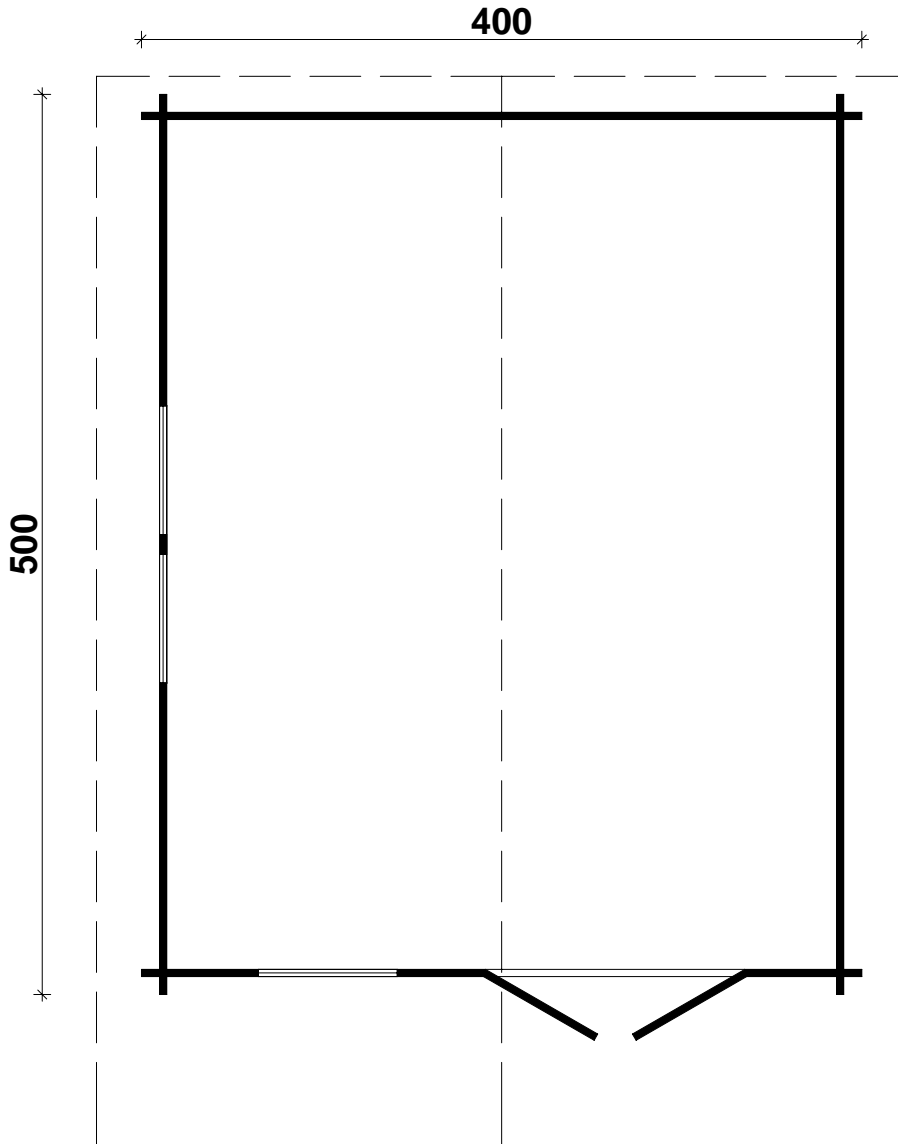

Note: All dimensions are approximate

Specification Enzo C/1 40

Nr.	Description	Profile mm	Length mm	Quantity	
001-1	Foundation		3790	2	
001-2			4650	7	
002-1			1910/650	1/1	
002-2			4000	1	
003			4000	17	
004			5000	22	
005			650	26	
006			1910	8	
007			1730	17	
008			490	9	
009			--	--	
010			--	--	
011			2030	1	
012			--	--	
013			--	--	
014			5300	1	
015			5575	2	
016				5950	2(1+1)
017	Purlin 			5950	5(4+1)
018	Gable 		4000	2	
019	Doubledoor ca. 1425 x 1955mm - 40 mm Standart +			1	
020	Doublewindow ca. 1530 x 990mm - 40 mm Standart +			1	
021	Window ca. 765 x 990mm - 40 mm Standart +			1	
022	Roofing felt			--	
023	Roof board		2300	136+2/110+2	
024	Floor board		3716	54+1/43+1	
025	Facia board		--	--	
026	Facia board		2340	4	
027	Eave edging		2340	4	
028	Roof edge reinforcement		5950	2	
029	Roof edge reinforcement		2975	4	
030	Diamond			2	
031	Baseboard		ca. 16,9 m		
032	Storm braces		2010	4	
033	Screws 4,0 x 40; 4,0 x 50; 5,0 x 70; 6,0 x 140			120/1000/15/60	

Specification Enzo C/1 40

Nr.	Description	Profile mm	Length mm	Quantity
034	Nails 1,4 x 50			50
035	Roofing nails 3,0 x 15			--
036	Bolt M 8 x 70, nut, washer			12
037	Hitblock		300-400	

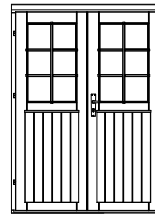

NR. 019
Double door 40 mm
1425 x 1955 mm
1 st.

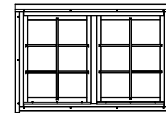

NR. 020
Double window 40 mm
1530 x 990 mm
1 st.

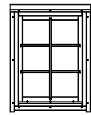

NR. 021
Window 40 mm
765 x 990 mm
1 st.

Foundation

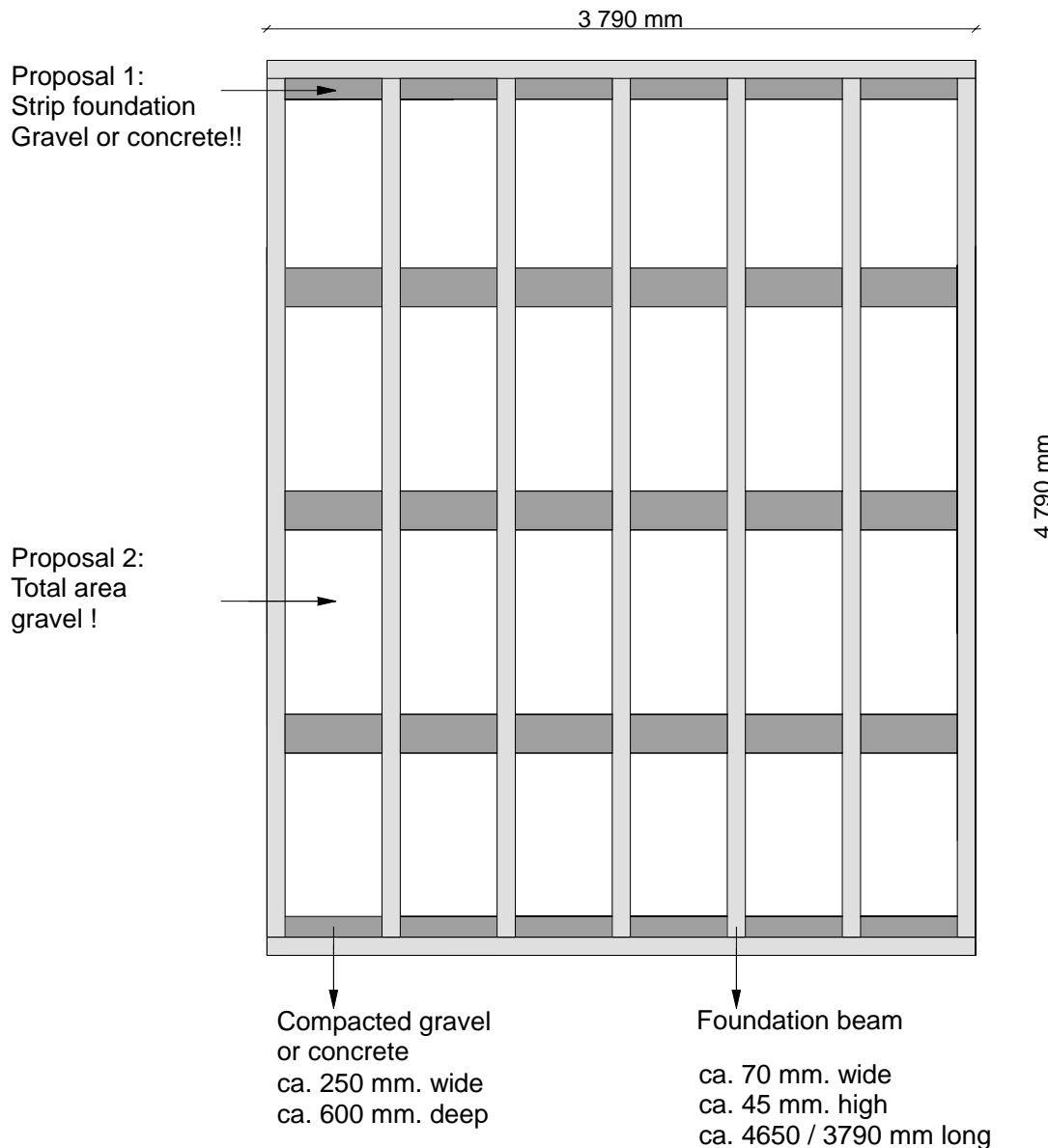

House	Number of foundation beams
Enzo C/1 40	2(ca. 70x45x3790 mm)
	7(ca. 70x45x4650 mm)

Enzo C/1 40 - 400 x 500 cm

Wall A

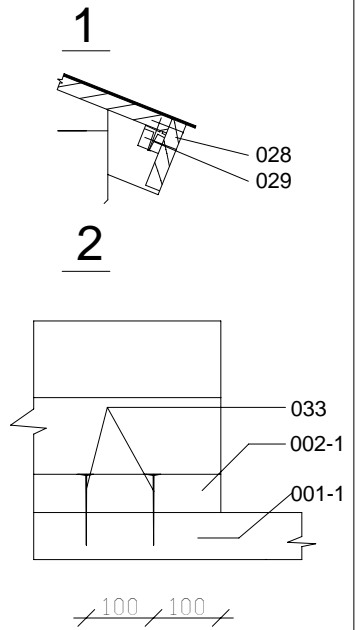
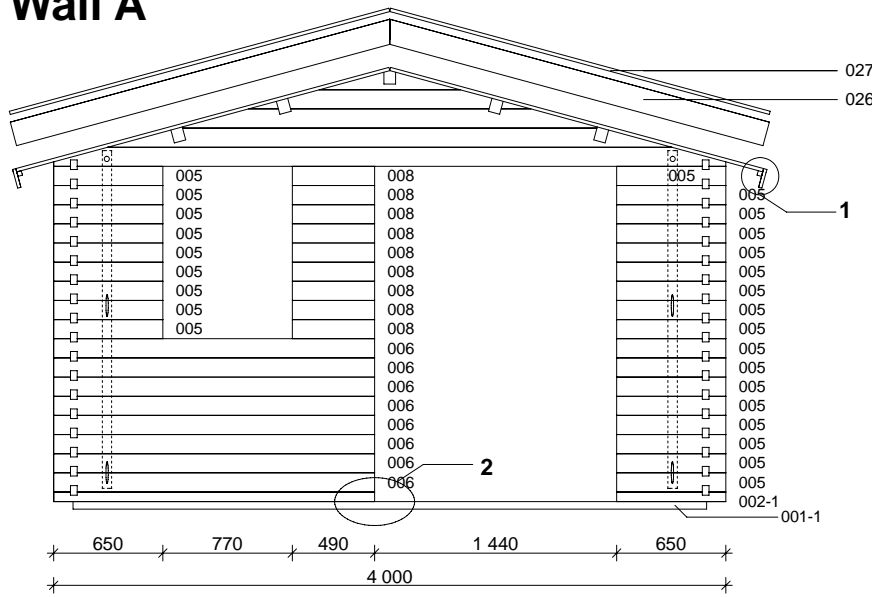

Wall B

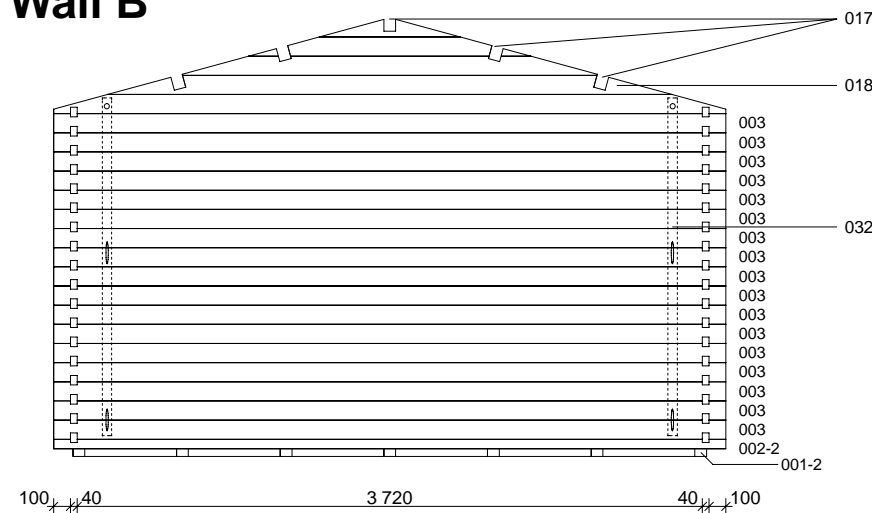

A-A

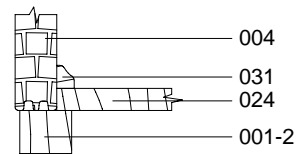

B-B

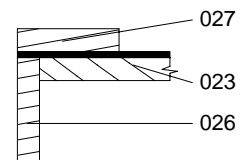

Wall C

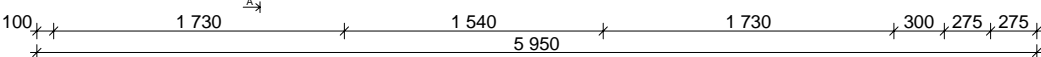
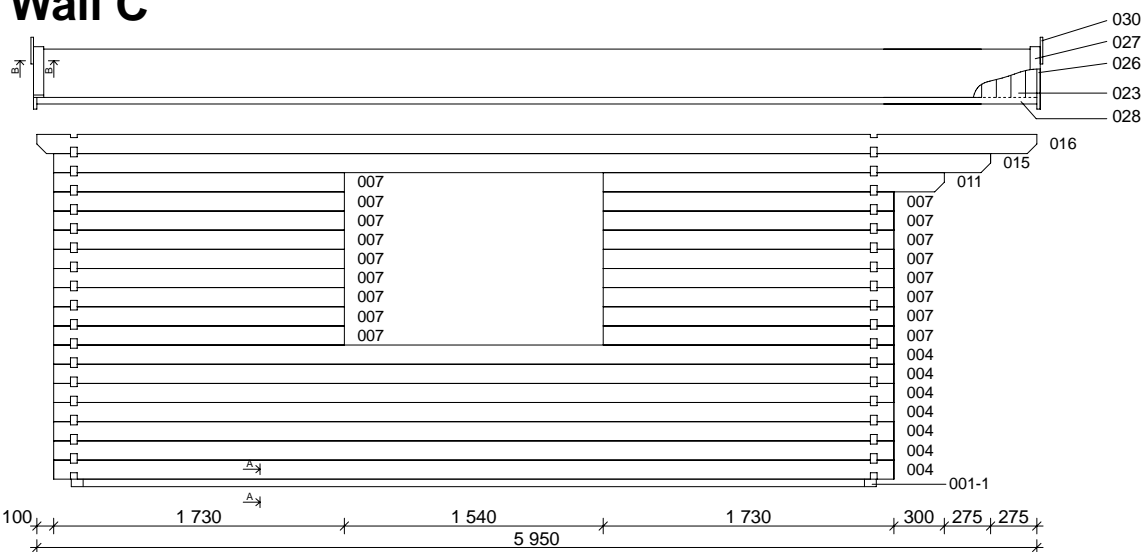

Enzo C/1 40 - 400 x 500 cm

Wall D

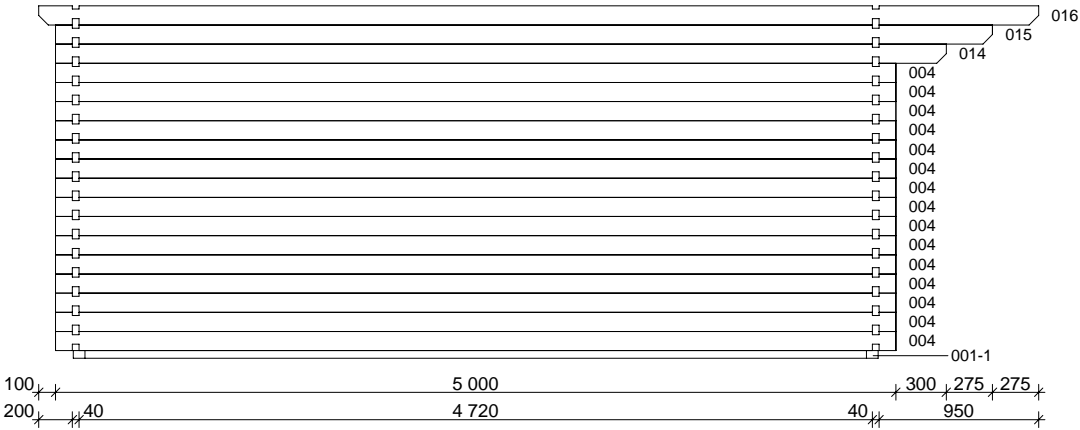

Wallplan

